

# Dynafluid 2000 - 3/4"

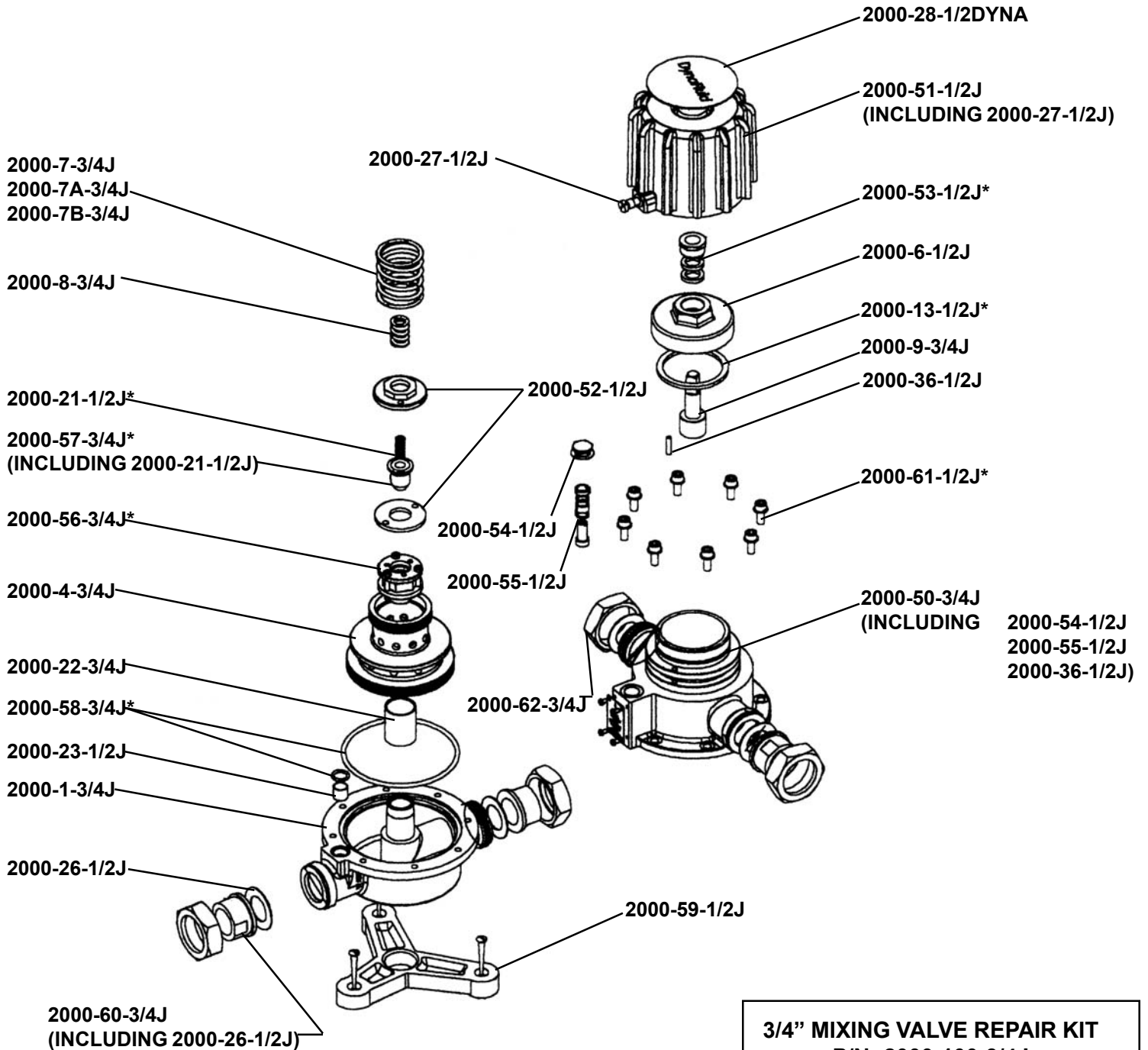

## 3/4" MIXING VALVE REPAIR KIT P/N: 2000-100-3/4J

INCLUDES: 2000-13-1/2J  
 2000-53-1/2J  
 2000-56-3/4J  
 2000-57-3/4J  
 2000-58-3/4J  
 2000-61-1/2J

## 3/4" DYNAFLUID VALVE

T&S Part Number	Dynafluid Part Number	New Dynafluid Part Number	Description
012767-45		2000-28-1/2DYNA	NAMEPLATE
005248-45	SPSV0015J		NAMEPLATE
012758-45		2000-51-1/2J	CONTROL KNOB
004115-45	SPSV0011J		CONTROL KNOB
012766-45		2000-27-1/2J	CONTROL KNOB SCREW
004094-45	769-27-1/2		CONTROL KNOB SCREW
004123-45		2000-53-1/2J	TOP CAP PACKING SET
004078-45		2000-6-1/2J	TOP CAP
004083-45		2000-13-1/2J	TOP CAP GASKET
004121-45		2000-9-3/4J	SPINDLE
004145-45		2000-36-1/2J	CONTROL KNOB STOPS
012770-45		2000-61-1/2J	COVER SCREWS & WASHERS
004142-45	SPSV0006J		COVER SCREWS & WASHERS
012777-45		2000-50-3/4J	COVER ASSEMBLY
004111-45	SPSV0046J		COVER ASSEMBLY
012783-45		2000-62-3/4J	SEALING PLUG & WASHER
004148-45	SPSV0019J		SEALING PLUG & WASHER
004085-45		2000-55-1/2J	INPUT VALVE & PACKING
004127-45		2000-54-1/2J	INPUT STOP & WASHER
004117-45		2000-7A-3/4J	FIXED SPRING 0-50 PSIG
004118-45		2000-7-3/4J	FIXED SPRING 50-100 PSIG
004120-45		2000-7B-3/4J	FIXED SPRING 100-150 PSIG
005029-45		2000-8-3/4J	VARIABLE SPRING
004129-45		2000-21-1/2J	STEAM VALVE SPRING
012761-45		2000-57-3/4J	STEAM VALVE & SPRING
004076-45		2000-52-1/2J	PISTON PLATES
012760-45		2000-56-3/4J	VALVE SEAT HOUSING ASSEMBLY
004116-45		2000-4-3/4J	SKIRTED PISTON
012762-45		2000-22-3/4J	SLEEVE
012779-45		2000-58-3/4J	COVER TO BASE SEAL
004131-45	770-24-3/4GL		COVER TO BASE GASKET
012771-45		2000-23-1/2J	RELIEF/LOCATION TUBE
004143-45	770-33-31/2		RELIEF/LOCATION TUBE
012775-45		2000-1-3/4J	BODY
004113-45	770-1-3/4J		BODY
012780-45		2000-26-1/2J	UNION GASKET
004133-45	MV22-3/4		UNION GASKET
012781-45		2000-60-3/4J	UNION ASSEMBLY
004134-45	PESL0018J		UNION ASSEMBLY
012764-45		2000-59-1/2J	BRACKET AND SCREWS
004090-45	SPSV0064J		BRACKET AND SCREWS
012785-45		2000-100-3/4J	VALVE REPAIR KIT
004108-45	SPSV0038J		VALVE REPAIR KIT